

WARRANTY

- ❑ The equipment is warranted for a period of 12 months from the date of purchase.
- ❑ The warranty is valid against defects of origin, whether of material or of manufacture.
- ❑ Whenever a malfunction occurs in the equipment, it must be returned as soon as possible, by adding the purchase document.
- ❑ When the warranty is triggered, damaged parts will be repaired or replaced, as the manufacturer understands. In the event of their replacement, the damaged parts will become the supplier's
- ❑ Any defects resulting from improper installation or use / handling of the equipment are excluded from the warranty.
- ❑ The equipment will lose its warranty whenever any change / modification or even repair is identified by the user.

P N H

BY PINHA
TASTE & INNOVATION

Use Instructions ***Stainless Steel Grease box***

PNH BY PINHA
RUA DO ALTO - VALE DO GROU – APARTADO 86
3750 - 064 AGUADA DE CIMA
TEL. +351 234 622 889 FAX. +351 234 624 044
comercial@pnh-bypinha.pt www.pnh-bypinha.pt

GENERAL FEATURES

- Fully built-in stainless steel.
- Removable stainless-steel cover.
- Grease trap separators.
- Basket with stainless steel perforated sheet feet with 2mm round holes.
- 4 stainless steel fasteners.
- Tube for water inlet and outlet.
- Drain valve with 3/4"

TABLE OF CHARACTERISTICS

Model	Product dimensions AxLxP (mm)	Net weight (Kg)	Gross Weight (Kg)	Packaging Dimensions xLxP (mm)
50L (33L USEFUL)	310X655X335	14	14,7	315X660X345

OPERATING PRINCIPLE

The operation of grease separators does not require energy consumption and is based on the gravitational separation of materials with a density different from that of water. The heavier materials (waste, sand, etc.) settle in the pre-settling compartment (basket) and are retained there. This compartment also retains fats that are in easily floatable forms. Only water and substances lighter than water, namely the grease to be separated, pass into the separation zone. The grease accumulates on the surface, while the clean water flows out at a level which does not allow the phases to mix



INSTRUCTIONS FOR USE

- Install the appliance in the desired location, connecting the water inlet and outlet.
- Empty the solid waste into the basket when it is full.
- Please note that the basket can clog quite easily depending on the type of use of the product and the waste to which it is exposed.

ASSEMBLY DIAGRAM

Adapt pvc tube 50 for
water waste inlet

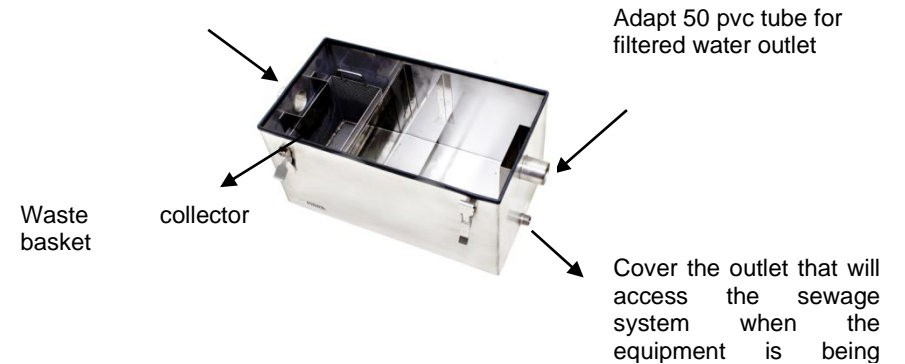

MAINTENANCE AND CLEANING

- Since it contains no electrical parts, the appliance can be immersed in water for a more efficient cleaning.
- When cleaning the appliance, do not use abrasive products which can damage it. It is recommended to use a cleaning product suitable for stainless steel.